

Wall End Run Cabinets

Construction Options and Modifications

- - - - Available with an upcharge
- ◆ - - - Included as standard
- (Blank) - Not available

- PE - - - Plywood Ends
- APC - - All Plywood Construction
- APFC - - All Plywood Furniture Construction
- DE - - - Integrated Decorative End
- FPEB - - Furniture Plywood Ends
- GD - - - Glass Doors
- ID - - - Increased Depth
- MI - - - Matching Interior
- RD - - - Reduced Depth
- XS - - - Extended Stile

WZA	12	30
code	width	height

Material dimensions may be nominal based on lumber industry standards.

Specifications subject to change without notice.

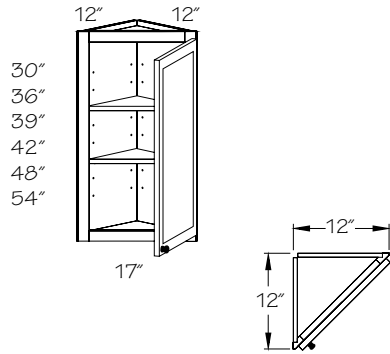

Wall Corner Angle

(price book pg. D44)

Specify R or L
Two Shelves

Three shelves, shipped separately

WCA1230 R or L ☆ **▲WCA1248 R or L**

Three Shelves

Four shelves shipped separately

WCA1236 R or L

WCA1239 R or L ☆ **▲WCA1254 R or L**

WCA1242 R or L

- ☆ **Not** available with mullion glass doors
- ▲ Available in full overlay door styles only
- ☆ Modern Frosted and Moire glass inserts **not** available on 54" H cabinets

- Adjustable shelves
- Back Options (BEB and VGRB) **not** available
- Contrasting Back Options (CBEB, CPLB, CVGR) **not** available

●	PE
●	APC
	APFC
●	DE
	FPEB
☆	GD
	ID
●	MI
	RD
	XS

Wall Corner Angle Stack

(price book pg. D44)

Two shelves

WCAST1248 R or L

Three shelves

WCAST1254 R or L

- Two vertical compartments with fixed rail and floor
- Bottom door is always square
- Available in full overlay door styles only
- Shelves shipped separately
- Contrasting Back Options (CBEB, CPLB, CVGR) **not** available
- ☆ Glass doors available for top doors only
- ☆ To get glass on bottom door, order appropriate replacement door with glass option

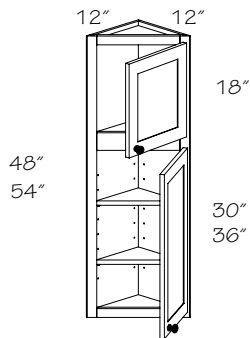

●	PE
●	APC
	APFC
●	DE
	FPEB
☆	GD
	ID
●	MI
	RD
	XS

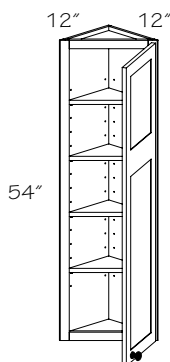

Wall Corner Angle Double Panel 54" H

(price book pg. D46)

WCADP1254 R or L

- Available in full overlay door styles only
- Shelves shipped separately
- **Not** available in mitered door styles
- **Not** available in slab door styles
- Contrasting Back Options (CBEB, CPLB, CVGR) **not** available
- ☆ Glass doors available for top section only
- A solid raised center panel machined to match the veneer raised center panel will be supplied when glass doors are selected on Full Overlay veneer raised panel door styles
- ☆ **Not** available with mullion glass doors

●	PE
●	APC
	APFC
●	DE
	FPEB
	GD
	ID
●	MI
	RD
	XS

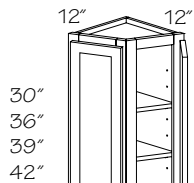

Wall End Corner

(price book pg. D46)

Two shelves

WEC1230

Three shelves

WEC1236

WEC1239

WEC1242

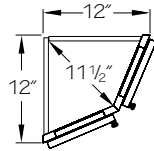

- Adjustable shelves
- Doors are square except full overlay arch door styles. Evana Cathedral and Findlay Cathedral door styles will be square. Greenwich, Harlowe, Smithton and Vanderbilt doors will have a solid, recessed flat panel.
- Back Options (BEB and VGRB) **not** available
- Contrasting Back Options (CBEB, CPLB, CVGR) **not** available

●	PE
●	APC
●	APFC
●	DE
●	FPEB
●	GD
●	ID
●	MI
●	RD
●	XS

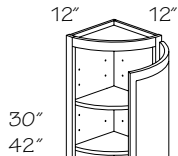

Wall End Corner w/Curved Door

(price book pg. D46)

Specify R or L

Two Shelves

WEC1230 R or L-CDO

Three Shelves

WEC1242 R or L-CDO

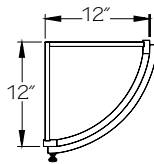

- 11 5/8" radius
- Adjustable shelves
- For Curved Moldings, see Molding section of this book
- Back Options (BEB and VGRB) **not** available
- Contrasting Back Options (CBEB, CPLB, CVGR) **not** available
- **Note:** Selected cherry door styles only

●	PE
●	APC
●	APFC
●	DE
●	FPEB
●	GD
●	ID
●	MI
●	RD
●	XS

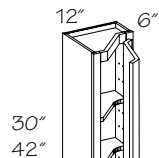

Wall Z-Angle

(price book pg. D46)

Specify R or L

Two Shelves

WZA1230 R or L

Three Shelves

WZA1242 R or L

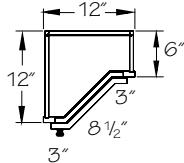

- Right shown
- Adjustable shelves
- Doors will **not** receive pegs when ordered in Abington, LaSalle & Morristown door styles
- Outside profile will contain eased edges and will **not** match straight doors for Rutherford, Lindsay and Northwicke door styles
- **Not** available in Brockton, Eldridge, all Fox Chase, Garrison, Harlowe, Harrington, Jamison, Judson, Kendrick, Lincoln, Patterson, Putnam Oak, North Hampton, Richland, Seton, Smithton, Tennyson & Vanderbilt
- Back Options (BEB and VGRB) **not** available
- Contrasting Back Options (CBEB, CPLB, CVGR) **not** available
- **Not** available in laminate door styles

☆ Reduced Depth (RD) available to 10" without shelves; 10 5/8" with shelves

●	PE
●	APC
●	APFC
●	DE
●	FPEB
●	GD
●	ID
●	MI
☆	RD
●	XS

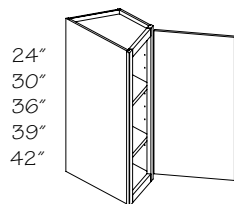

Wall End Angle

(price book pg. D46)

One Shelf

WEA1224 R or L

Two Shelves

WEA1230 R or L

Three Shelves

WEA1236 R or L

WEA1239 R or L

WEA1242 R or L

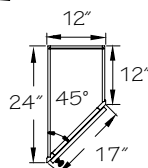

- Designed to be a transition cabinet between a 12" deep wall cabinet and a 24" deep tall or Wall Refrigerator cabinet
- Adjustable shelves
- Right shown
- ☆ Minimum Reduced Depth (RD) is 18"
- ☆ Integrated Decorative End (DE) available on 12" deep side only

●	PE
●	APC
●	APFC
☆	DE
●	FPEB
●	GD
●	ID
●	MI
☆	RD
●	XS

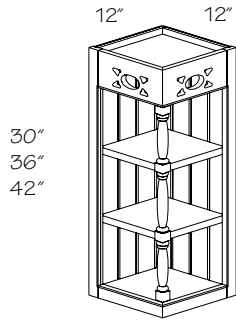

Wall End Open Frieze

(price book pg. D46)

Two Shelves

WEOF1230

WEOF1236

Three Shelves

WEOF1242

- 5/8" wood veneer construction
- Fixed shelves
- Reversible, may be used on either right or left end
- Wood veneer Beaded Back
- Add -NF for no charge no fret option
- **Not** available in Morristown; Melrose and Brockton are plain sawn wood
- Contrasting Back Options (CBEB, CPLB, CVGR) **not** available

PE
● APC
APFC
DE
FPEB
GD
ID
❖ MI
RD
XS

Wall End Open Shelf

(price book pg. D48)

Specify R or L

(3) 8 13/16" sections

WEOS630 R or L

WEOS630 R or L-SQT

WEOS630 R or L-SQB

WEOS630 R or L-SQTB

WEOS930 R or L

WEOS930 R or L-SQT

WEOS930 R or L-SQB

WEOS930 R or L-SQTB

WEOS1230 R or L

WEOS1230 R or L-SQT

WEOS1230 R or L-SQB

WEOS1230 R or L-SQTB

(4) 7 15/16" sections

WEOS636 R or L

WEOS636 R or L-SQT

WEOS636 R or L-SQB

WEOS636 R or L-SQTB

WEOS936 R or L

WEOS936 R or L-SQT

WEOS936 R or L-SQB

WEOS936 R or L-SQTB

WEOS1236 R or L

WEOS1236 R or L-SQT

WEOS1236 R or L-SQB

WEOS1236 R or L-SQTB

(4) 8 11/16" sections

WEOS639 R or L

WEOS639 R or L-SQT

WEOS639 R or L-SQB

WEOS639 R or L-SQTB

WEOS939 R or L

WEOS939 R or L-SQT

WEOS939 R or L-SQB

WEOS939 R or L-SQTB

WEOS1239 R or L

WEOS1239 R or L-SQT

WEOS1239 R or L-SQB

WEOS1239 R or L-SQTB

(4) 9 7/16" sections

WEOS642 R or L

WEOS642 R or L-SQT

WEOS642 R or L-SQB

WEOS642 R or L-SQTB

WEOS942 R or L

WEOS942 R or L-SQT

WEOS942 R or L-SQB

WEOS942 R or L-SQTB

WEOS1242 R or L

WEOS1242 R or L-SQT

WEOS1242 R or L-SQB

WEOS1242 R or L-SQTB

PE
● APC
APFC
DE
FPEB
GD
ID
❖ MI
☆ RD
XS

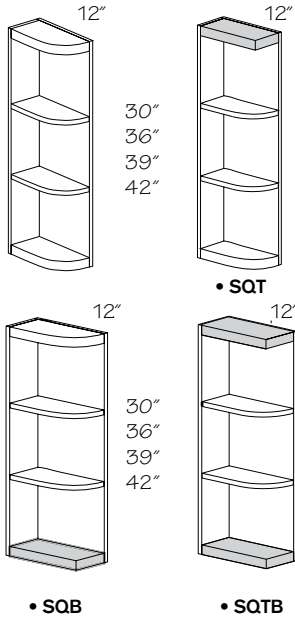

- 5/8" wood veneer construction
- 1 3/16" thick top and bottom shelves
- Left shown
- Back Options (BEB and VGRB) **not** available
- **Not** available in Morristown; Melrose and Brockton are plain sawn wood
- Contrasting Back Options (CBEB, CPLB, CVGR) **not** available
- ☆ Reduced Depth (RD) available in 3" increments to a minimum of 6"



Remember, order Wall End Open Shelves (WEOS) with a Square Top (-SQT) when applying top molding.

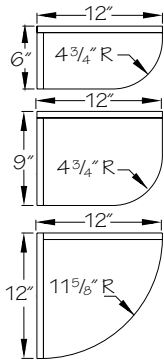

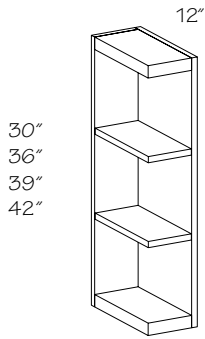

Wall End Open Shelf Mission

(price book pg. D50)

(3) 8 3/4" sections

WEOS630 R or L-M

WEOS930 R or L-M

WEOS1230 R or L-M

(4) 7 29/32" sections

WEOS636 R or L-M

WEOS936 R or L-M

WEOS1236 R or L-M

(4) 8 21/32" sections

WEOS639 R or L-M

WEOS939 R or L-M

WEOS1239 R or L-M

(4) 9 13/32" sections

WEOS642 R or L-M

WEOS942 R or L-M

WEOS1242 R or L-M

- 1 1/4" thick top and bottom shelves
- Left shown
- Quartersawn wood veneer construction
- Available in quartersawn oak door styles only
- Contrasting Back Options (CBEB, CPLB, CVGR) **not** available
- ☆ Reduced Depth (RD) available in 3" increments to a minimum of 6"

PE
● APC
APFC
DE
FPEB
GD
ID
◆ MI
☆ RD
XS

Solid Wood Wall End Open Shelf

(price book pg. D52)

Specify R or L

(3) 8 13/16" sections

SWEOS630 R or L

SWEOS630 R or L-SQT

SWEOS630 R or L-SQB

SWEOS630 R or L-SQTB

SWEOS930 R or L

SWEOS930 R or L-SQT

SWEOS930 R or L-SQB

SWEOS930 R or L-SQTB

SWEOS1230 R or L

SWEOS1230 R or L-SQT

SWEOS1230 R or L-SQB

SWEOS1230 R or L-SQTB

(4) 7 15/16" sections

SWEOS636 R or L

SWEOS636 R or L-SQT

SWEOS636 R or L-SQB

SWEOS636 R or L-SQTB

SWEOS936 R or L

SWEOS936 R or L-SQT

SWEOS936 R or L-SQB

SWEOS936 R or L-SQTB

SWEOS1236 R or L

SWEOS1236 R or L-SQT

SWEOS1236 R or L-SQB

SWEOS1236 R or L-SQTB

(4) 8 11/16" sections

SWEOS639 R or L

SWEOS639 R or L-SQT

SWEOS639 R or L-SQB

SWEOS639 R or L-SQTB

SWEOS939 R or L

SWEOS939 R or L-SQT

SWEOS939 R or L-SQB

SWEOS939 R or L-SQTB

SWEOS1239 R or L

SWEOS1239 R or L-SQT

SWEOS1239 R or L-SQB

SWEOS1239 R or L-SQTB

(4) 9 7/16" sections

SWEOS642 R or L

SWEOS642 R or L-SQT

SWEOS642 R or L-SQB

SWEOS642 R or L-SQTB

SWEOS942 R or L

SWEOS942 R or L-SQT

SWEOS942 R or L-SQB

SWEOS942 R or L-SQTB

SWEOS1242 R or L

SWEOS1242 R or L-SQT

SWEOS1242 R or L-SQB

SWEOS1242 R or L-SQTB

PE
☆ APC
APFC
DE
FPEB
GD
ID
◆ MI
☆ RD
XS

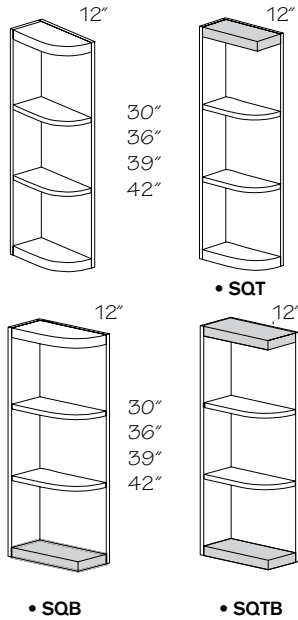

- 5/8" wood veneer on sides and back
- 1 3/16" thick top and bottom shelves
- Left shown
- Laminates are painted hardwood
- Solid wood construction on shelves only
- Back Options (BEB and VGRB) **not** available
- **Not** available in Morristown; Melrose and Brockton are plain sawn wood
- Contrasting Back Options (CBEB, CPLB, CVGR) **not** available
- ☆ Shelves remain solid when APC option is chosen; sides and back will be 11/16" matching wood veneer plywood
- ☆ Reduced Depth (RD) available in 3" increments to a minimum of 6"

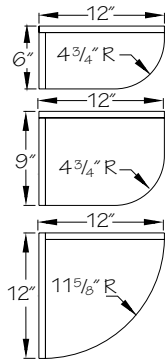

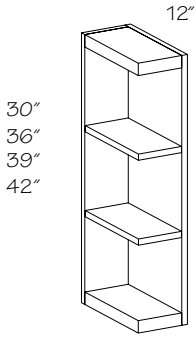

Solid Wood Wall End Open Shelf Mission

(price book pg. D54)

(3) 8 13/16" sections

SWEOS630 R or L-M

SWEOS930 R or L-M

SWEOS1230 R or L-M

(4) 7 15/16" sections

SWEOS636 R or L-M

SWEOS936 R or L-M

SWEOS1236 R or L-M

(4) 8 11/16" sections

SWEOS639 R or L-M

SWEOS939 R or L-M

SWEOS1239 R or L-M

(4) 9 7/16" sections

SWEOS642 R or L-M

SWEOS942 R or L-M

SWEOS1242 R or L-M

- 1 3/16" thick top and bottom shelves
- Left shown
- Quartersawn wood veneer construction on sides and back
- Solid standard oak on shelves only
- Available in quartersawn oak door styles only
- Contrasting Back Options (CBEB, CPLB, CVGR) **not** available
- ☆ Shelves remain solid when APC option is chosen; sides and back will be 11/16" matching wood veneer plywood
- ☆ Reduced Depth (RD) available in 3" increments to a minimum of 6"

PE
☆ APC
APFC
DE
FPEB
GD
ID
❖ MI
☆ RD
XS