

Specifications subject to change without notice.

<b>PBDR</b>	<b>12</b>
code	depth

### Sidemount Drawer Runners

(price book pg. M1)

**PDR18**

**PDR21**

**PDR24**

- 50 pound capacity
- Almond
- Used for Roll-out Trays (ROT)
- Packaged and sold per pair

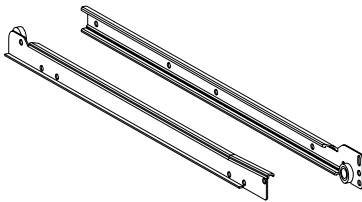

### Ultimate Full Extension Drawer Runners

(price book pg. M1)

**PBUFDR12**

**PBUFDR15**

**PBUFDR18**

**PBUFDR21**

**PBUFDR24**

- 75 pound capacity
- Fully concealed
- Packaged and sold per pair
- Ball bearing operation
- Integrated drawer buffer
- Auto soft-close feature
- Must order drawer clips separately (PBDC)

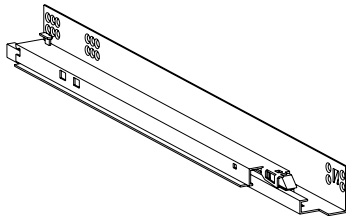

### Ultimate Heavy Duty Full Extension Drawer Runners

(price book pg. M1)

**PHDBFDR21**

**PHDBFDR24**

- 100 pound capacity
- Integrated drawer buffer
- Fully concealed
- Ball bearing operation
- Auto soft-close feature
- Packaged and sold per pair
- Must order drawer clips separately (PBDC)
- Used for:

BPPS\_•2—Base Pot and Pan Organizer Two Drawer

BDDC—Base Deep Drawer Combination

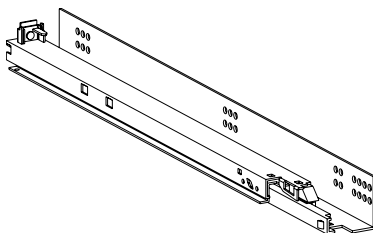

### Full Extension Drawer Runner

(price book pg. M1)

- ✦ **PFDR12**
- PFDR15**
- PFDR18**
- PFDR21**
- PFDR24**
- ✦ Used for:
  - DS—Drawer Storage
  - FD—Furniture Drawer
  - FW—Furniture Wall

- 75 pound capacity
- Used for:
  - DDFD—Desk Double File Drawer
  - WAD—Wall Angle Drawer
  - WMSP—Wall Multi-Storage Pantry
- Packaged and sold per pair

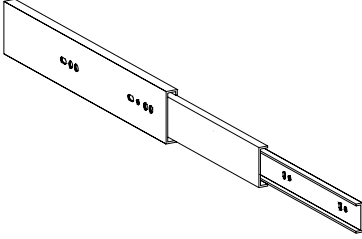

### Base Pantry Pull-out Runners

(price book pg. M1)

#### **PBPPDR24**

- 75 pound capacity
- Packaged and sold per pair
- Integrated drawer buffer
- Used for:
  - BPP—Base Pantry Pull-out
  - BLB—Base Liter Bottle

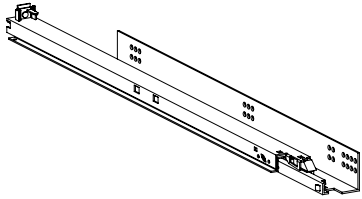

### Deluxe Dovetailed Full Extension Roll-out Tray Drawer Runners

(price book pg. M1)

#### **PDXR18**

#### **PDXR21**

#### **PDXR24**

- Fully concealed
- Ball bearing operation
- Integrated drawer buffer
- 75 pound capacity
- Packaged and sold per pair

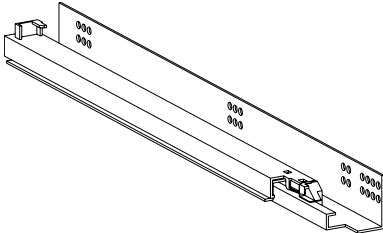

### Ultimate Drawer Runner Clips

(price book pg. M1)

#### **BOX -BDC**

- Box of ten, five left and five right

#### **PBDC**

- Packaged and sold per pair

#### **PBDC -S**

- Used on VSB 36•2D
- Packaged and sold per pair

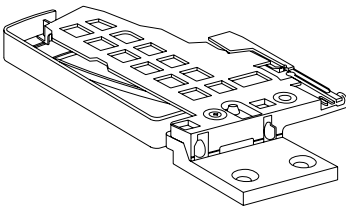

### Adjustable Door Buffer Kit

(price book pg. M1)

**-FADBK**

❖ **BOX -FADBK**

*Color coding indicates new product, size or code*

- ❖ Ten per box
- Pre-drilling required for installation
- Fits in standard shelf hole drillings on end panel
- Installation instructions included
- May interfere with Roll-out Tray (ROT) and shelf placement
- Mounting hardware included
- Field installation only

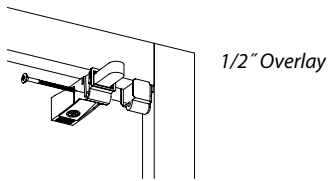
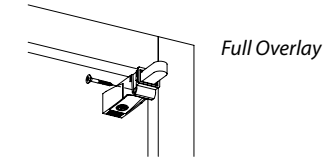

### Door Stop Kit

(price book pg. M1)

**DSTK**

- Nylon coated stainless wire rope
- Stainless eyes with aluminum collar
- Mounting hardware included

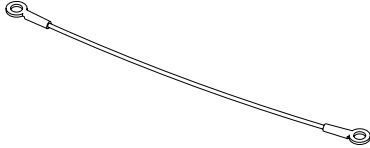

### Hanging Pot Rack Hardware Kit

(price book pg. L1, L2, M1)

**HPRHK**

- Six hooks per kit
- Available in Cherry and Maple door styles only

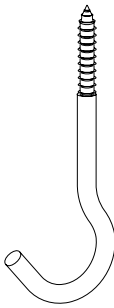

### ROT Mounting Block Kit

(price book pg. M1)

**ROTK-R**

- Includes mounting blocks, drawer glide mounting sleeves and fasteners

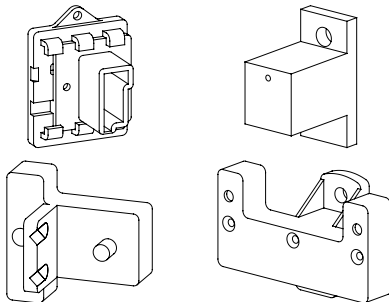

### Deluxe Dovetailed Roll-out Tray Mounting Block Kit

(price book pg. M1)

#### DXROTK

- Includes mounting blocks, drawer glide mounting sleeves and fasteners

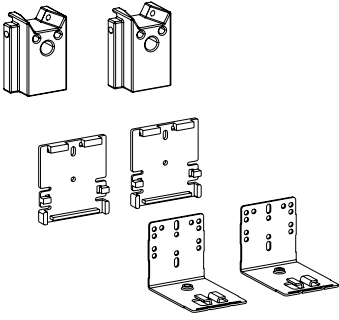

### Shelf Clips

(price book pg. M1)

**BOX •SC12** For 1/2" thick shelves

**BOX •SC34** For 3/4" thick shelves

- Clear plastic locking clip
- Ten per box

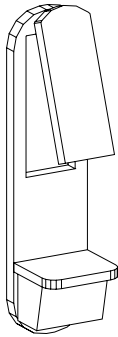

### Front Shelf Clips

(price book pg. M1)

#### BOX •SCF

- Clear plastic locking clip
- Plastic front edge restraint
- Ten per box (Five left and five right)

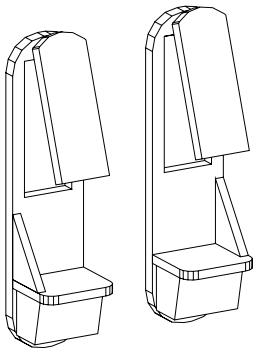

### Adjustable Shelf Clips

(price book pg. M1)

#### BOX •ASC

- Ten per box
- Adjustable clip locks in eight positions for approximately 1 5/8" of vertical adjustment
- Includes slip resistant pads
- Wood shelves may need to be trimmed to accommodate the thickness of this clip

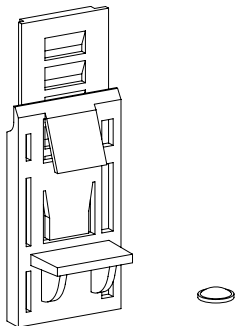

**Door Insert Clips***(price book pg. M1)***BOX •IC**

- Burnished brass finish
- Mounting screws included
- Eight per box

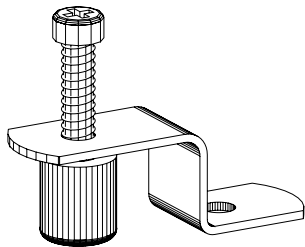
**Glass Shelf Rests***(price book pg. M1)***BOX •GSR**

- Twelve per box
- Polished chrome finish with slip resistant pad

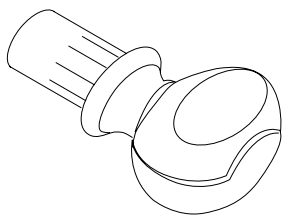
**Furniture Shelf Rests***(price book pg. M1)***BOX •FSR**

- Satin chrome
- For use in any cabinet
- Ten per box

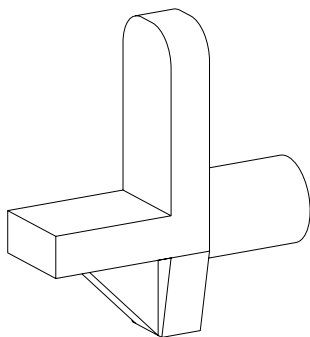
**Hardware Screws***(price book pg. M1)***BOX •HS**

- Specify door or drawer and hardware type
- Example: BOX•HSDOOR for 205 hardware
- Ten per box

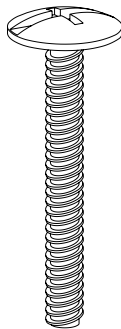

**Installation Screws**

(price book pg. M1)

**BOX •IS**

- Ten packs per box
- Each pack includes 4 mounting screws and 2 cabinet-to-cabinet screws

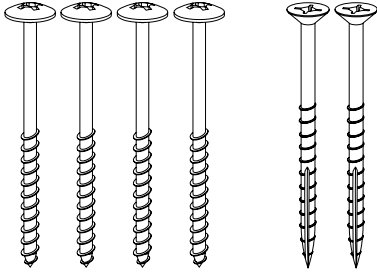

**Permaset Bumpers**

(price book pg. M2)

**BOX •PSDB**

- Opaque "Eversoft" rubber door bumpers
- Ten per box

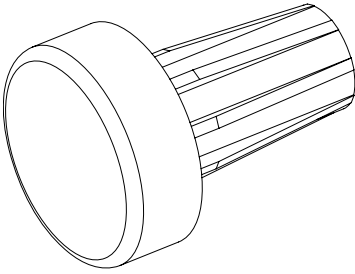

**False Front Clips**

(price book pg. M2)

**BOX •SFFC**

- Mounting hardware included
- Ten per box

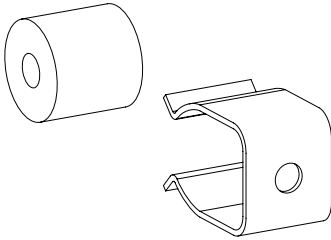

**Glass Insert Retainer Strip**

(price book pg. M2)

**MDRS**

- Holds decorative glass in a door frame
- Used with the following decorative glass inserts: Bistro, Geometra, Keystone, Linen, Mirage, Moire, Montrose, Portico, Prairie, Ravenna, Rhythm, Tapestry, Villa
- Specify length needed, in feet

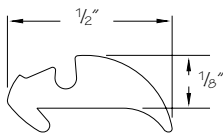

### Hinges—Full Overlay

(price book pg. M2)

#### PH1516FO-6

- Six-way adjustable hinge
- Nickel plated finish
- Packaged and sold per pair

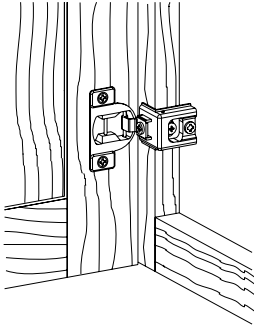

### Hinges—Full Overlay Wall Angle

(price book pg. M2)

#### PH1516WA

- Nickel plated finish
- Packaged and sold per pair

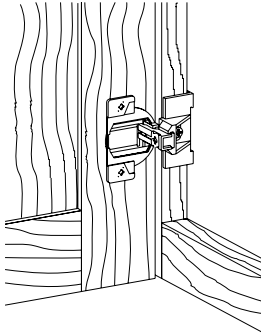

### Hinges—Face Mount

(price book pg. M2)

#### PHFM

- Nickel plated finish
- For oven cabinets
- Packaged and sold per pair

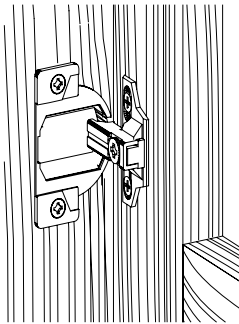

### Hinges— 1/2" Overlay

(price book pg. M2)

#### PH12C

- Six-way adjustable hinge
- Nickel plated finish
- Packaged and sold per pair

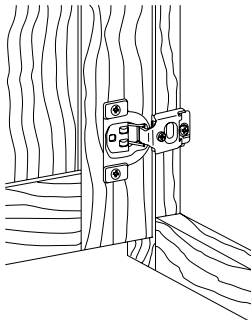

**Hinges-1" Overlay***(price book pg. M2)***PH1PO-6**

- Six-way adjustable hinge
- Nickel plated finish
- Packaged and sold per pair

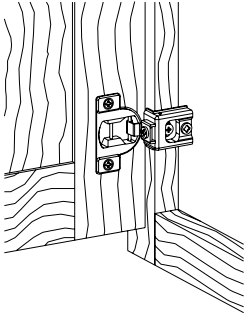
**Hinges-Partial Overlay Concealed***(price book pg. M2)***PH12PO**

- Nickel plated finish
- Packaged and sold per pair
- Used for Wall Top Hinge and Keyboard Drawer cabinets in non-full overlay door styles

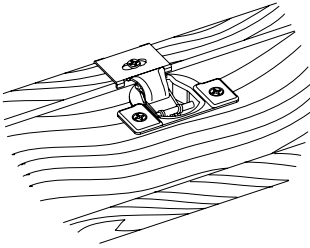
**Knife Hinges***(price book pg. M2)***PH12K**

- Burnished brass finish
- Packaged and sold per pair

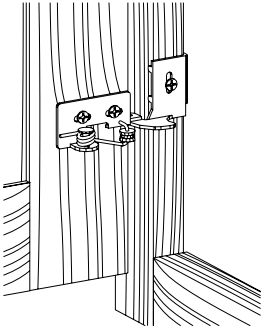
**Hinges-Ezy-Fold***(price book pg. M2)***HEZF**

- White
- For WEZR36
- Packaged and sold each

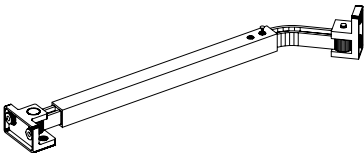

### Hinges—110° For Wall Dome Top

(price book pg. M2)

#### PH110

- Nickel plated finish
- Packaged and sold per pair

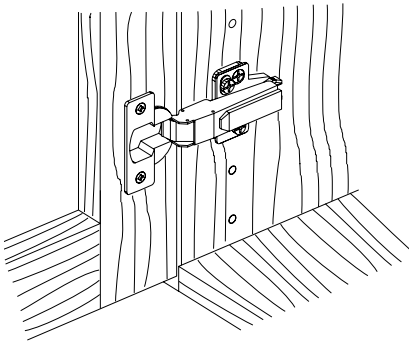

### Hinges—Partial Or Full Overlay Easy Reach

(price book pg. M2)

#### PH170EZ

- Nickel plated finish
- Packaged and sold per pair
- Used for Wall Ironing Board Cabinet (WIB)

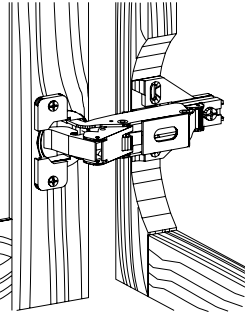

### Hinges—Bi-Fold

(price book pg. M2)

#### PHBF

- Nickel plated finish
- Packaged and sold per pair

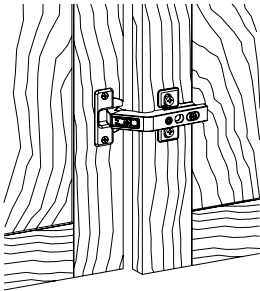

### Casters

(price book pg. M2)

**ACS** Aluminum

**SCS** Stainless

- Set of four
- 300 pound capacity
- Mounting hardware **not** included
- Decorative feet, casters or legs should support the cabinet by way of the end panels, **not** the cabinet floor

